

S-137 State of New York

R-105

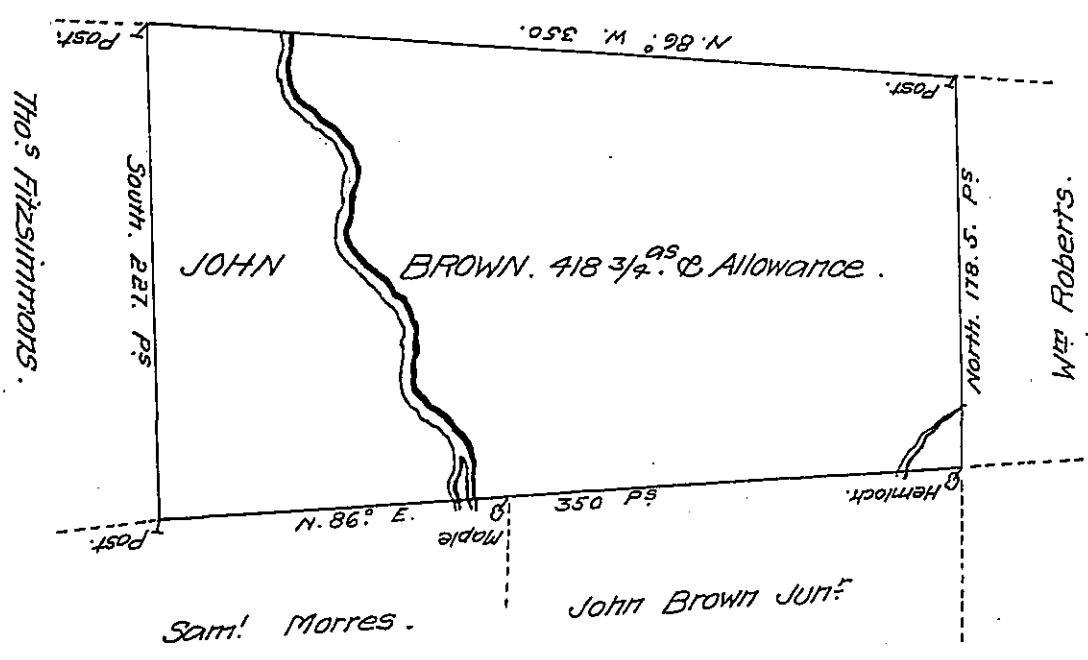

D 29-224

A draught of a tract of Land Called \_\_\_\_\_ Situate on a branch of Appalacunt  
 Creek Joining Land Surveyed for Tho<sup>s</sup> Fitzsimmons (obl.) others in State Township North<sup>d</sup>  
 County Containing four Hundred & Eighteen acres  $\frac{3}{4}$  & Allowance of Six P. Cent  
 for Roads. Surv<sup>d</sup> for John Brown Sen<sup>r</sup> the 20<sup>th</sup> Day of July 1784. in Pursuance of a  
 Warrant Dated the 2<sup>d</sup> Day of July 1784.

by W<sup>m</sup> Gray D. obl.

To John Lutens Esq<sup>r</sup>  
 Surv<sup>r</sup> Gen<sup>l</sup>

IN TESTIMONY that the above is a copy of the original remaining on file in  
 the Department of Internal Affairs of Pennsylvania, made  
 conformably to an Act of Assembly approved the 16th day of  
 February, 1833, I have hereunto set my Hand and caused  
 the Seal of said Department to be affixed at Harrisburg,  
 this twenty fifth day of February 1908.

*Henry Howett*  
 Secretary of Internal Affairs.